



Design and Migration Services with Ranplan Software Solutions

Providing a cost-efficient and proficient partner
to excel your wireless network planning projects

Ranplan Design Services

Empowering your network planning

To ensure that your organisation progresses in the rapidly developing environment of network planning, we offer services that will remove obstacles to attain network perfection. Our software isn't just a tool; it's a catalyst for streamlining processes, enhancing accuracy, and ultimately saving valuable time and resources.

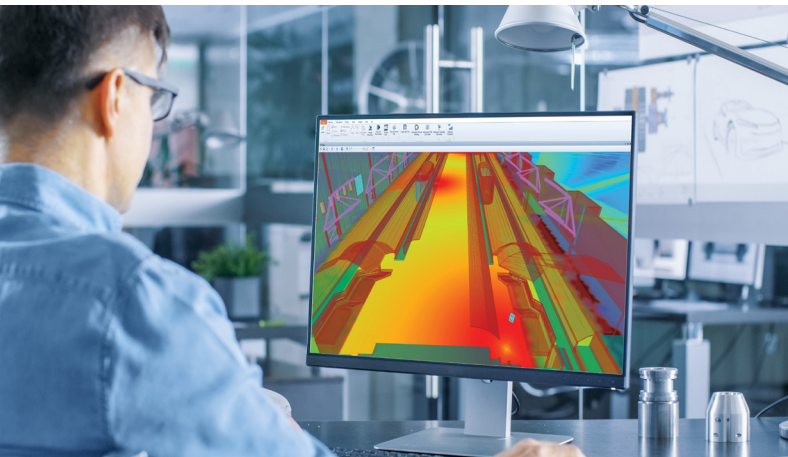

Enhancing your productivity

Mastering the most advanced and sophisticated network planning software available to engineers can seem like a daunting task. Yet, our customers' experience shows that such investments in the Ranplan network planning software tools can be paid back within months, if not weeks.



Enhance Productivity

Experience a remarkable 50% boost in network planning productivity, accelerating the pace of network deployment.



Reduce Cost

By harnessing the power of our optimisation tools to streamline your designs, you can attain up to a 30% reduction in CAPEX/OPEX.



Train Engineers

Lean on our dedicated support team, committed to guiding you every step of the way, ensuring your network planning success.

Our commitment

At Ranplan, our commitment to innovation and client satisfaction remains unwavering. With our Onboard and Assist Services, we aim to equip you with the tools and expertise needed to excel in the world of network planning. Let's embark on this transformative journey together, ensuring that your network infrastructure stands strong, resilient, and ready for whatever the future holds.

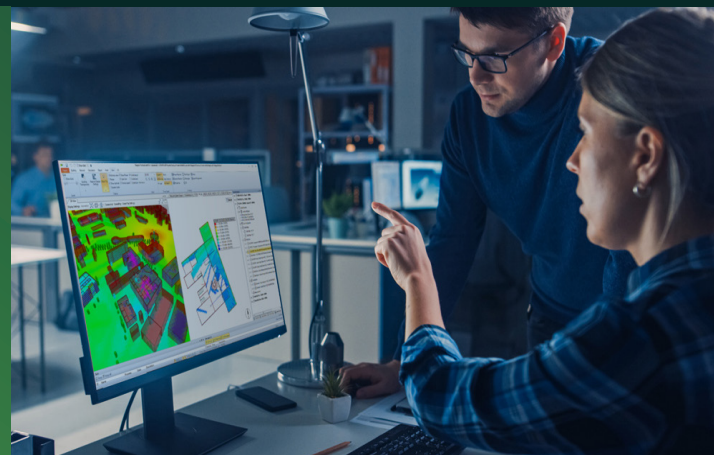

RANPLAN ONBOARD

Accelerate your capabilities

Our Onboarding service is designed to support and accelerate your journey in adopting the Ranplan network planning software. Our team of experts are dedicated to ensuring that you not only understand the software's features and functionalities but also acquire the skills and knowledge needed to maximise its use. With personal guidance and hands-on training sessions, we help you get started, bolstering your efficiency and productivity.



RANPLAN ASSIST

Helping you perfect network design

Whether you're faced with complex projects or exacting requirements, our Design Assist Service provides you with a cost-efficient and proficient partner to tackle the most intricate network challenges head-on. Powered by Ranplan's state-of-the-art suite of software, our team of experts will work closely with you to analyse, craft, and implement solutions that meet your objectives from both a cost and performance perspective. With our help, you can take on the most demanding projects comfortably and confidently. Together, we can explore joint opportunities, bringing complementary resources and skills to the commercial benefits of all stakeholders.



RANPLAN MIGRATE

Convert your legacy designs

Our migration service converts legacy network design files from diverse planning software into versatile IFC open formats. With our expertise and efficient methods, we eliminate the need for rebuilding entire networks and expedite the seamless transition to Ranplan's innovative network planning tools. This streamlined process liberates your time, allowing you to concentrate on optimizing and enhancing your network to meet the latest industry demands. Embrace the future of wireless connectivity without constraints, as Ranplan Migrate simplifies your transition and empowers collaboration across open platforms.

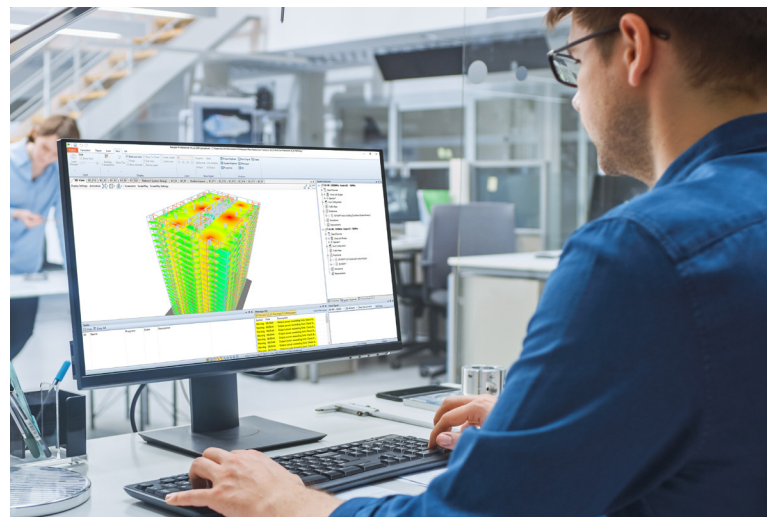



Revolutionising the way
wireless networks are planned
in a smart connected world



About Ranplan Wireless

Ranplan Wireless pioneer software solutions for the design, optimization and automation of in-building and urban outdoor wireless networks. Our open platform, intelligent automation and 3D ray-tracing simulations streamline the network planning process, expertly identifying potential issues and optimizing network performance for reliable connectivity. This results in an unparalleled quality of service, ensuring seamless and efficient wireless communication for end-users and businesses.

Ranplan Wireless is a subsidiary of Ranplan Group AB (Nasdaq First North: RPLAN) whose head office is in Stockholm, Sweden. The group operates out of offices in the UK, USA and China.

www.ranplanwireless.com  sales@ranplanwireless.com

